



A Maxcess
International
Company

Magnetic Power Systems, Inc.

1626 Manufacturers Drive. Fenton, MO 63026

Tel: 636.343.5550 | Fax: 636.326.0608 | magpowr@magpowr.com

INSTRUCTION MANUAL LC500G SINGLE STRAND 500 GRAM LOAD CELLS

DO NOT HAMMER ON LOAD CELL OR TAMPER WITH THE INTERNAL COMPONENTS

INTRODUCTION

The LC-500G load cell is designed to be mounted through the vertical face of a machine side frame. This load cell can be provided with a single strand pulley, or is available with an M5 threaded hole for a customer supplied pulley. Do not exceed a bolt torque limit of 25 in-lb maximum or sensor beam damage may occur.

MOUNTING

Select a clean flat surface where the wrap angle of the web does not change. The force direction arrow must bisect the wrap angle of the web and point in the same direction as the resultant tension force as shown in Figure 1. Secure jam nuts (supplied) tightly to either side of mounting surface to assure load cell body cannot rotate.

The pulley position can be adjusted by moving the jam nuts on the threaded sensor body.

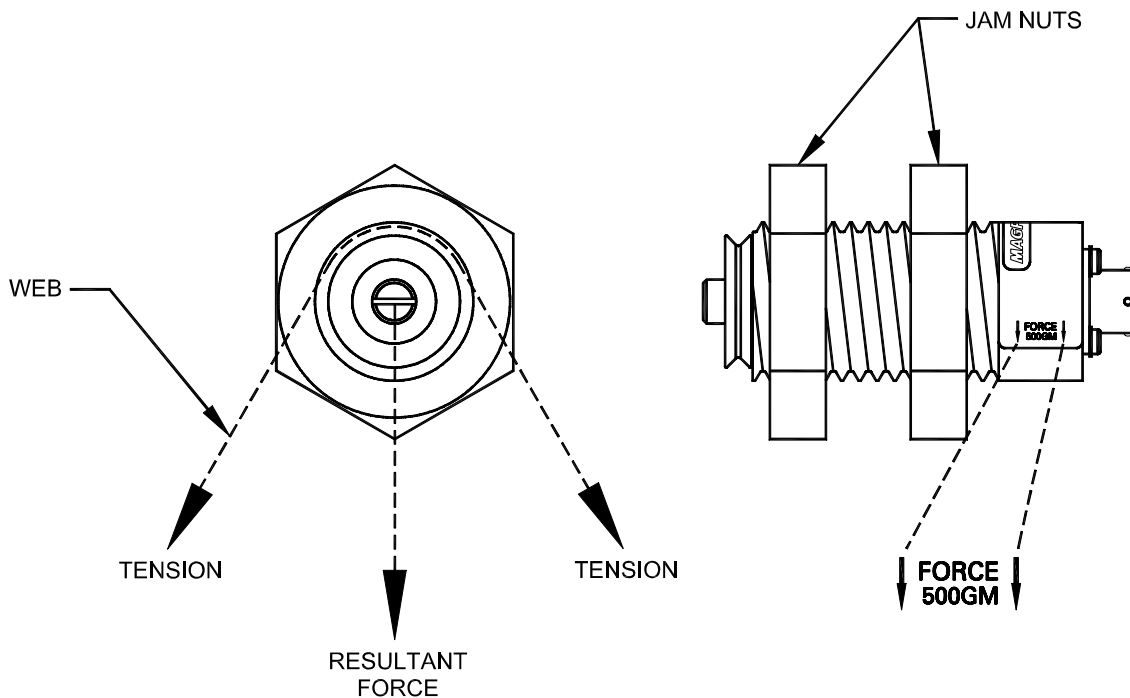

Figure 1

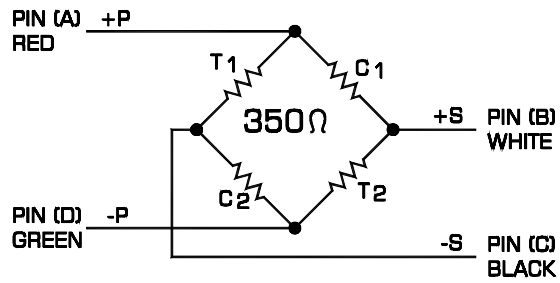

Figure 2

SPECIFICATIONS

Gage resistance	350 ohms
Excitation voltage	10 vdc nominal
Output Signal	21 mvdc nominal per sensor at full load rating
Operating Temperature	-30°C to 95°C
Combined Non-Linearity & Hysteresis	0.5% of full scale maximum
Repeatability	0.02% of full scale maximum
Electrical Connector	Magpowr Part # 12A97-1, Bendix Part # PT07-10-6P
Temperature Effect on Zero	0.02% of rating per °C
Climate Class	3K3 (EN60721)
Deflection at Full Load	0.02 maximum

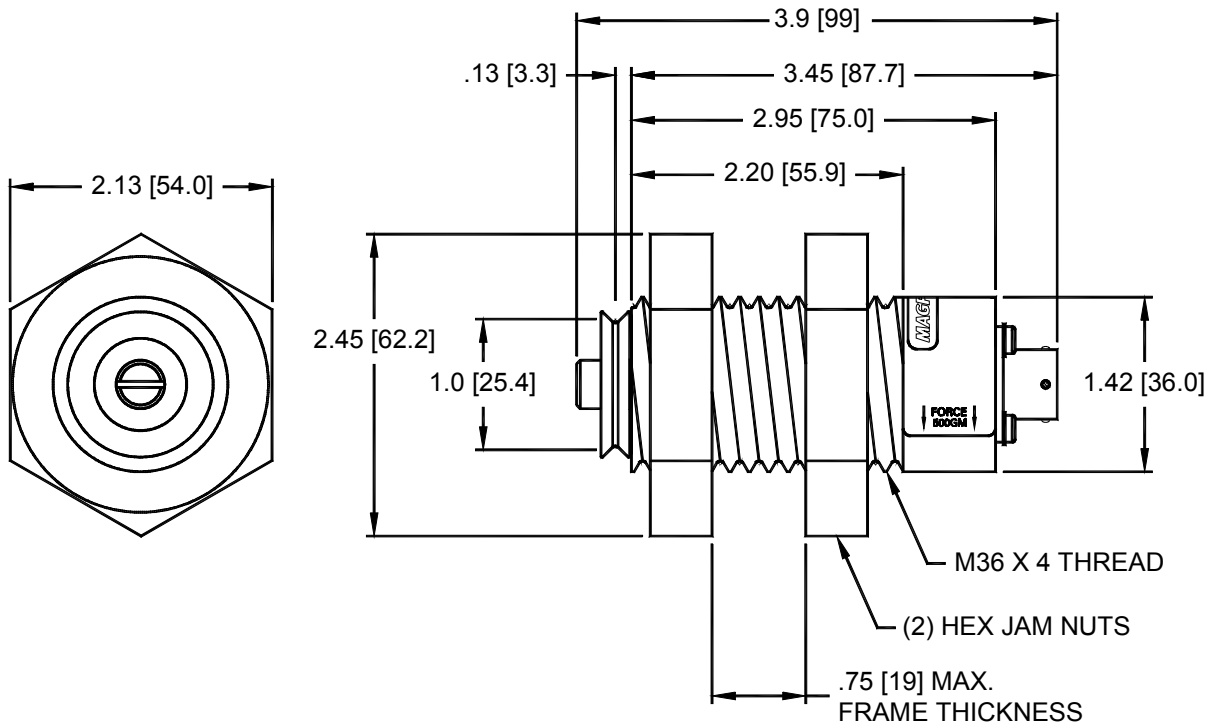

Figure 3